

CT LINE シェルフ

Design / Victor Vasilev ヴィクター ヴァシレフ



STRUCTURE

本体：アクリル樹脂（ホワイト）/ペーパーストーン（ブラック）

*壁面にビス固定の為、事前に下地材が必要です

*シェルフの耐荷重は1枚あたり最大10kgです



code

price

CTLINE - Single unit, wall-mounted - H 1260 mm

A / W360 x D258 x H1260

B / W409 x D307 x H1260

C / W459 x D356 x H1260

A	CCDDB036	¥ 189,000 (207,900)
B	CCEDB040	¥ 203,000 (223,300)
C	CCFDB045	¥ 217,000 (238,700)

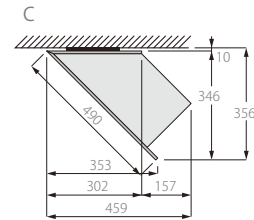
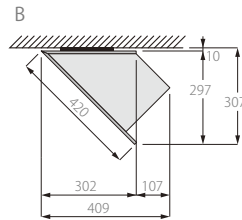
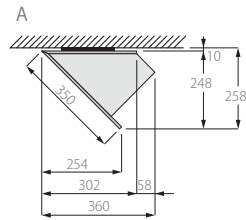
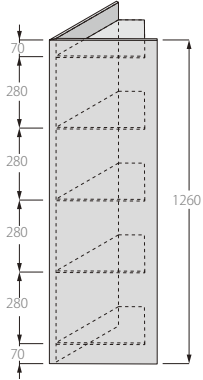
**CTLINE - Single unit, wall-mounted - H 1680 mm.**

D / W360 x D258 x H1680

E / W409 x D307 x H1680

F / W459 x D356 x H1680

D	CCGDB036	¥ 234,000 (257,400)
E	CCHDB040	¥ 240,000 (264,000)
F	CCIDB045	¥ 259,000 (284,900)

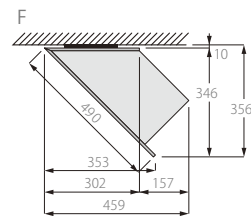
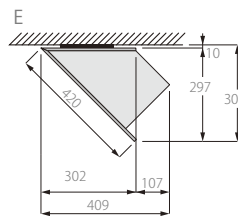
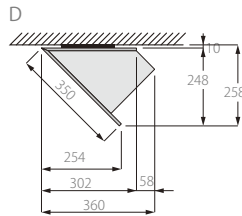
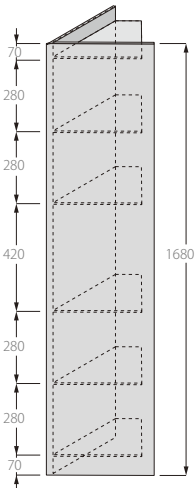
**CTLINE - Single unit, wall-mounted,with MIRROR- H 1680 mm.**

G / W366 x D264 x H1680

H / W415 x D313 x H1680

G	CCGKD036	¥ 280,000 (308,000)
H	CCHKD040	¥ 290,000 (319,000)

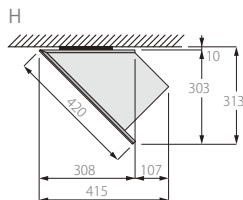
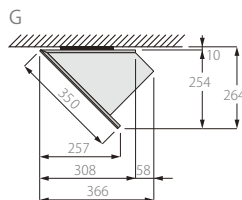
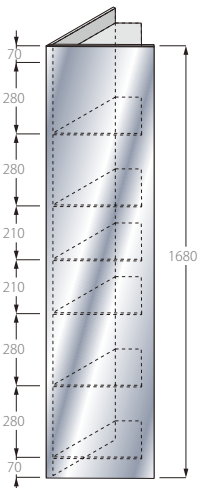

※ 表示価格は2024年8月現在の日本円、税抜価格（税込価格）です。
 ※ 寸法の単位はmmです。

Composition 1

¥ 1,912,000 (2,103,200)

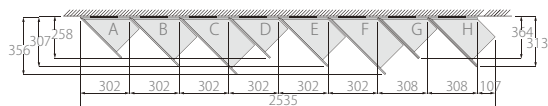
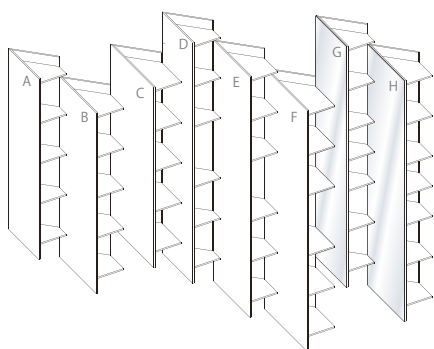

code

- A CCDBB036 x 1
- B CCEDB040 x 1
- C CCFDB045 x 1
- D CCGDB036 x 1
- E CCHDB040 x 1
- F CCIDB045 x 1
- G CCGKD036 x 1
- H CCHKD040 x 1

Composition 2

¥ 787,000 (865,700)

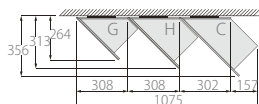
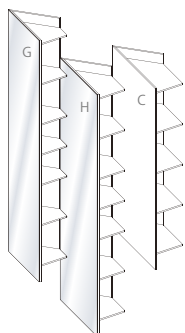

code

- G CCGKD036 x 1
- H CCHKD040 x 1
- C CCFDB045 x 1

※ 表示価格は2024年8月現在の日本円、税抜価格（税込価格）です。
 ※ 寸法の単位はmmです。